

CONFIGURE OUTLOOK 2007 JUNK E-MAIL CLIENT FILTER

Set the options in Outlook junk e-mail to treat your contacts as safe senders.

Click on the **Tools** menu; click on **Options**, and on **Junk E-mail**.

Click on the **Safe Senders** tab. Exempt your contacts and people that you send email to by checking the appropriate boxes.

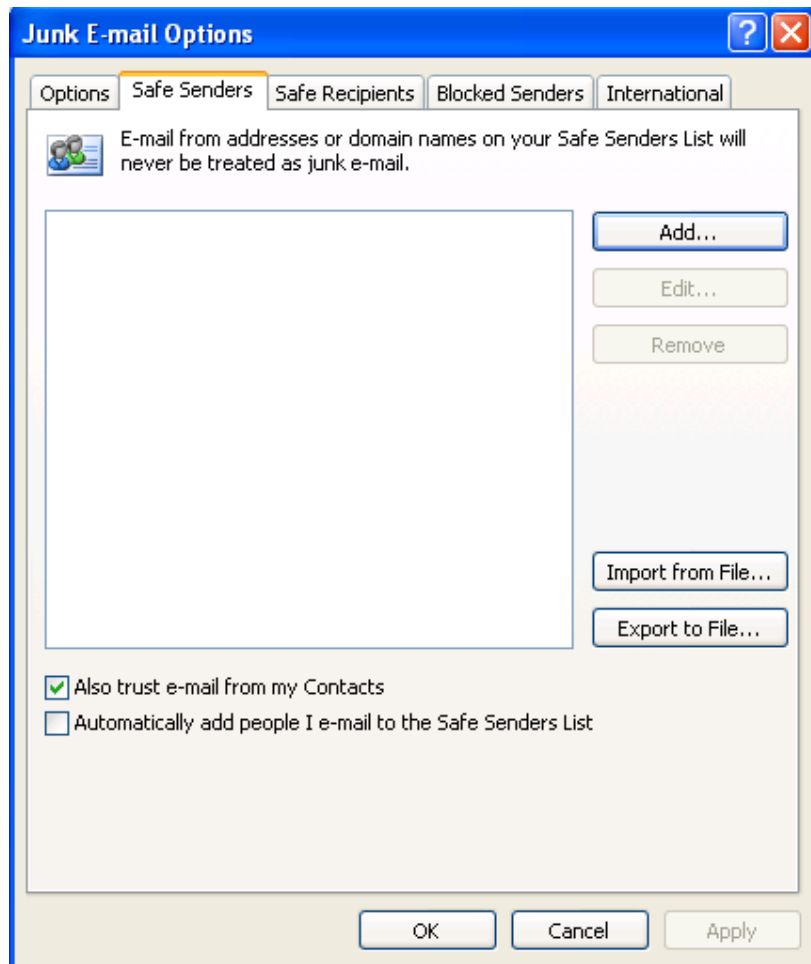

Click on **Add** to add a particular address or a domain to the safe senders list.

Enter the person's e-mail address or domain name (@mu.edu).

Click on **OK**.

